

Data Sheet

B METERS GMDM-I

Multi Jet-Super Dry Pre-Equipped For Inductive Modules



Supplied by

247able.com

Call us on +44 (0)118 916 9420 | Email info@247able.com

mod.

GMDM-I

Getto multiplo quadrante asciutto predisposto per moduli induttivi
Multi jet-super dry pre-equipped for inductive modules



Disponibile versione
acqua calda 30-90°C

Available version
for hot water 30-90°C

ITA

Getto multiplo, quadrante asciutto, trasmissione magnetica con coperchio girevole a 360°. Versione per acqua fredda e acqua calda. Predisposizione induttiva per l'installazione di moduli di trasmissione dati M-BUS cablati, wireless M-BUS, lancia impulsi di tipo amagnetico e LoRa.

ENG

Multi-jet, dry dial, magnetic transmission with 360° rotating lid. Versions for cold water and hot water. Inductive pre-equipment for the installation of data communication modules M-BUS wired and wireless M-BUS, non-magnetic pulse output and LoRa.

ESP

Chorro múltiple, esfera seca, de transmisión magnética con tapa orientable 360°. Realizado en las versiones para agua fría y agua caliente. Predisposición inductiva para módulos de telemetría M-BUS cable y wireless M-BUS, de pulsos amagnétique y LoRa.

FRA

Jet multiple, cadran sec, entrainement magnétique avec capot orientable à 360°. Version pour eau froide et eau chaude. Pre-équipement inductif pour modules de télérelève M-BUS filaire et radio M-BUS, avec émetteur d'impulsions amagnétique et LoRa.

Moduli compatibili
Compatible modules

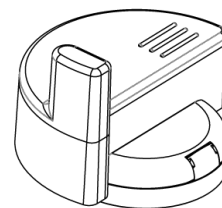

mod. **IWM-LR3**
LoRaWAN

mod. **IWM-TX3**
M-Bus

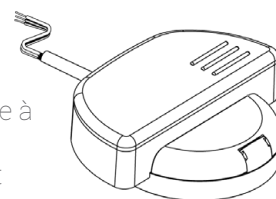

mod. **IWM-MB3**
M-Bus

mod. **IWM-PL3**
PULSE

| Calibro Size | | DN (inch) | 15 (1/2") | 20 (3/4") | 25 (1") | 32 (1"1/4) | 40 (1"1/2) | 50 (2") | |
|--|--|----------------|-------------------|--------------|------------|---------------|---------------|------------|-------|
| R=100 H ↑ | Portata di sovraccarico Overload flow rate | Q ₄ | m ³ /h | 3,125 | 5 | 7,875 | 12,5 | 20 | 31,25 |
| | Portata permanente Permanent flow rate | Q ₃ | m ³ /h | 2,5 | 4 | 6,3 | 10 | 16 | 25 |
| R=160 H ↑* | Portata di transizione Transitional flow rate | Q ₂ | L/h | 40 | 64 | 100,8 | 160 | 256 | 400 |
| | Portata minima Min flow rate | Q ₁ | L/h | 25 | 40 | 63 | 100 | 160 | 250 |
| R=50 VH → | Portata di transizione Transitional flow rate | Q ₂ | L/h | 80 | 128 | 201,6 | 320 | 512 | 800 |
| | Portata minima Min flow rate | Q ₁ | L/h | 50 | 80 | 126 | 200 | 320 | 500 |
| Sensibilità Sensitivity | | L/h | 6 | | 10 | | 20 | | |
| Lettura minima Min reading | | L | 0,05 | | | | | | |
| Lettura massima Max reading | | m ³ | 99,999 | | | 999,999 | | | |
| Pressione max ammissibile Max admissible pressure MAP | | bar | 16 | | | | | | |

*Versione su richiesta solo acqua fredda
*Version on request only cold water

Versione base - Basic version

- R100-H ↑ R50-VH →
- Versione acqua fredda 0,1°C-50°C
- Versione acqua calda 30°C-90°C
- Trasmissione magnetica
- Protezione anti-frode magnetica
- Lettura diretta su 5 rulli numeratori (6 rulli numeratori su DN40 e DN50)
- Quadrante asciutto
- Coperchio girevole a 360° (DN15-DN32)

- R100-H ↑ R50-VH →
- Cold water version 0,1°C-50°C
- Hot water 30°C-90°C
- Magnetic transmission
- Anti-magnetic fraud protection
- Direct reading on 5 numeric rolls (6 numeric rolls on DN40 and DN50)
- Dry dial
- 360° rotating lid (DN15-DN32)

Su richiesta - Upon request

- Versione acqua fredda R160-H ↑ R50-VH →
- Cold water version R160-H ↑ R50-VH →

Posizione d'installazione - Installation position

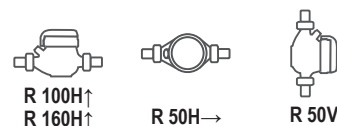

Dimensioni e pesi - Dimensions and Weights

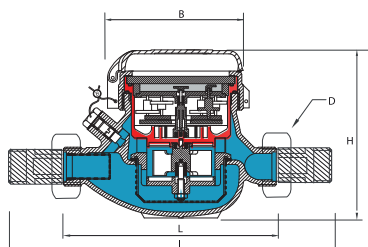

| Calibro Size | DN (inch) | 15 (1/2") | 20 (3/4") | 25 (1") | 32 (1"1/4) | 40 (1"1/2) | 50 (2") |
|-----------------|--------------------------|--------------|--------------|------------|---------------|---------------|--------------|
| L | mm | 145-165-190 | 190 | 260 | 260 | 300 | 300 |
| I | mm | 225-245-270 | 288 | 360 | 380 | 440 | 460 |
| H | mm | 109 | 111 | 117 | 117 | 153 | 172 |
| B | mm | 100 | 100 | 104 | 104 | 126 | 160 |
| D | Filettatura Threading | in | 3/4" | 1" | 1"1/4 | 1"1/2 | 2" |
| Pesi Weight | Kg | 1,18-1,41 | 1,40 | 2,09 | 2,18 | 4,38 | 4,46 9,40 |

Filettatura - Threading EN ISO 228-1:2003

I contatori DN50 possono essere forniti flangiati secondo ISO 7005-2 / EN 1092-2 PN16
The DN50 meters can be supplied flanged according to ISO 7005-2 / EN 1092-2 PN16

